

Lumen Tech

Lighting, LLC.

Design F219T

Adjustable Trunnion Mount Flood Light
With Lens Guard Maximum 400W Metal Halide
Or High Pressure Sodium

Specifications

Housing: Heavy duty cast aluminum with silicone gasket. Powder coated finish. See finish note.

Lens: Clear tempered glass silicone sealed to door frame.

Reflector: Anodized aluminum, computer designed for efficiency.

Ballast: Pre-wired C.W.A., H.P.F. core and coil with capacitor.

Lamp: Clear mogul base. (by others).

Lamp Holder: High heat 4 K.V. rated, w/nickel plated copper screw shell, spring loaded center contact.

Finish: Bronze, detergent cleaned, prime coated chip resistant powder urethane polyester coating. Contact factory for other colors.

Photometric Information: Contact factory.

Labels: U/L, CUL listed suitable for wet location.

SPECIFICATIONS SUBJECT TO CHANGE WITHOUT NOTICE

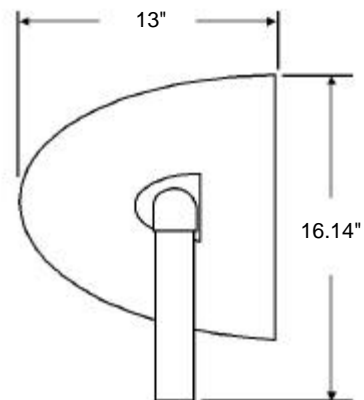

Ordering Information

Catalog Number	Watts	Light Source
F219T250H	250	HPS
F219T400H	400	HPS
F219T250M	250	MH
F219T250MP	250	MH Pulse Start
F219T320MP	320	MH Pulse Start
F219T350MP	350	MH Pulse Start
F219T400M	400	MH
F219T400MP	400	MH Pulse Start

